

TS13C HVC

FEATURES

- 105°C 2000h assured
- Low ESR, Solid capacitors of SMD type
- Polymer

◆ Specifications

I T E M S		C H A R A C T E R I S T I C S	
Operating Temperature Range(°C)		-55~+105	
Capacitance Tolerance (20°C, 120Hz)		±20%	
Rated Voltage Range (V)		2.5~16	
Dissipation Factor (20°C, 120Hz)		Less than the specification (20°C, 120Hz)	
Leakage Current (μ A)		Less than the specification (20°C, 0.2CV, 2min)	
Equivalent Series Resistance		Less than the specification (20°C, 120Hz)	
Loading Life 105°C, 2000h Rated Voltage Applied	Capacitance change rate	Less than ±20% of the initial value	
	Dissipation Factor	Less than 150% of the specified value	
	ESR	Less than 150% of the specified value	
	Leakage Current	Less than the specified value	
Moisture Resistance 60°C, 90-95%RH, 100h Rated Voltage Applied	Capacitance change rate	Less than ±20% of the initial value	
	Dissipation Factor	Less than 150% of the specified value	
	ESR	Less than 150% of the specified value	
	Leakage Current	Less than the specified value	
Surge Voltage Characteristic 105°C, 1000cycles Surge Voltage Applied	Capacitance change rate	Less than ±20% of the initial value	
	Dissipation Factor	Less than 150% of the specified value	
	ESR	Less than 150% of the specified value	
	Leakage Current	Less than the specified value	
Standard		Satisfies Characteristic W of JIS-C-5101-1	

◆ Diagram of Dimensions

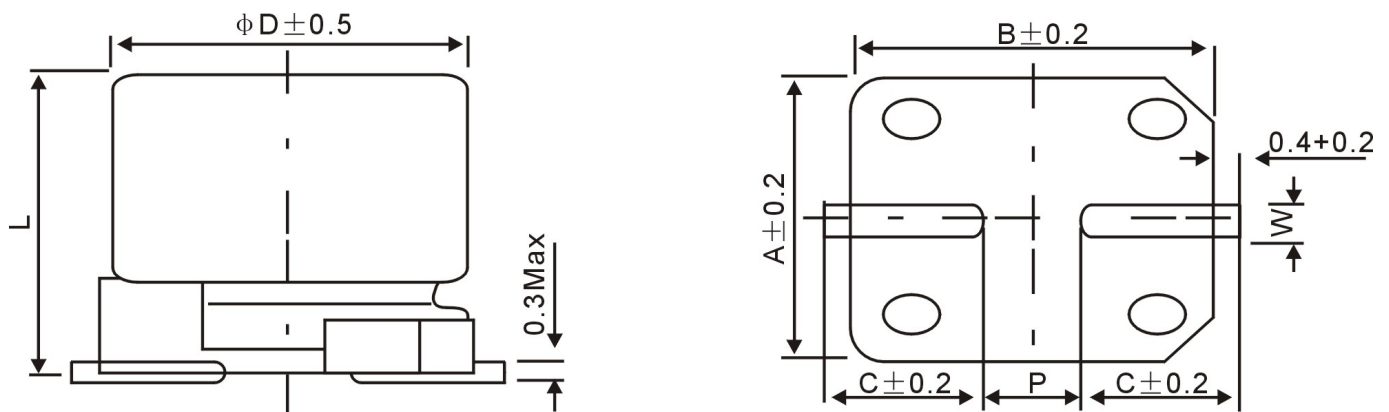

◆ LEAD SPACING AND DIAMETER

Code	ØD	L	A	B	C	W	P±0.2
B12	8	11.8±0.5	8.4	8.4	3.0	0.7~1.1	3.1
C13	10	12.7±0.5	10.4	10.4	3.3	0.7~1.1	4.7

TS13C HVC

◆ STANDARD RATINGS

Rated Voltage (V)	Capacitance (μ F)	Tan δ (120Hz)	ESR (100KHz) (m Ω)	Max Ripple Current 100KHz 105°C (m Arms)	\varnothing DxL (mm)
2.5	680	0.18	13	4520	\varnothing 8x11.8
	1000	0.18	13	5200	\varnothing 10x12.7
	1500	0.18	12	5440	\varnothing 10x12.7
4	560	0.18	13	4520	\varnothing 8x11.8
	1200	0.18	12	5440	\varnothing 10x12.7
6.3	470	0.15	15	4210	\varnothing 8x11.8
	820	0.15	12	5440	\varnothing 10x12.7
10	330	0.15	17	3950	\varnothing 8x11.8
	560	0.15	13	5230	\varnothing 10x12.7
16	100	0.15	25	3320	\varnothing 8x11.8
	150	0.15	20	4320	\varnothing 10x12.7

Note: Specification are subject to change without notice. For more detail and update, please visit our website.